

## DIGITAL OUTSIDE NECK CALIPERS (NON-WATERPROOF)

**DATA OUTPUT**

- Measure grooves and recesses
- Resolution: 0.01mm/0.0005"
- Buttons: on/off, zero, mm/inch
- Automatic power off, move the digital unit to turn on power
- Battery CR2032
- Data output
- Made of stainless steel
- Optional accessory: depth stop (code **6143**), data output cable (code **7315-**, **7302-**, **7305-**, for calipers without built-in wireless)

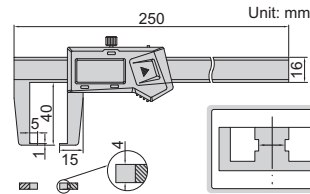

**1187-150A**

**depth stop 6143 (optional)**

| Code               | Range        | Accuracy | Wireless          |
|--------------------|--------------|----------|-------------------|
| <b>1187-150A</b>   | 0-150mm/0-6" | ±0.04mm  | no                |
| <b>1187-150AWL</b> |              |          | built-in wireless |

**DATA OUTPUT**

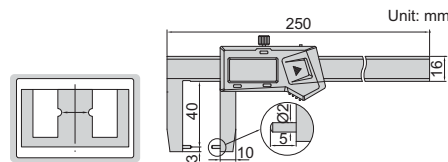
## DIGITAL OUTSIDE POINT CALIPERS (NON-WATERPROOF)

- Measure wall thickness inside bores and recesses
- Resolution: 0.01mm/0.0005"
- Buttons: on/off, zero, mm/inch
- Automatic power off, move the digital unit to turn on power
- Battery CR2032
- Data output
- Made of stainless steel
- Optional accessory: depth stop (code **6143**), data output cable (code **7315-**, **7302-**, **7305-**, for calipers without built-in wireless)

**1185-150A**

**depth stop 6143 (optional)**

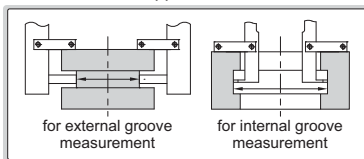

| Code               | Range        | Accuracy | Wireless          |
|--------------------|--------------|----------|-------------------|
| <b>1185-150A</b>   | 0-150mm/0-6" | ±0.04mm  | no                |
| <b>1185-150AWL</b> |              |          | built-in wireless |

application

**6143**
**Code**  
**6143**

## DEPTH STOP FOR CALIPERS

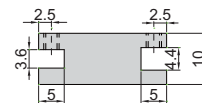
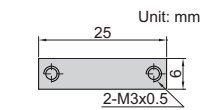
- Supplied in pair
- Made of stainless steel
- Suitable for caliper series **1124**, **1526**, **1530**, **1520**, **1176**, **1178**, **1120**, **1121**, **1187** and **1185**



## DIGITAL SMALL POINT CALIPERS (NON-WATERPROOF)

**DATA OUTPUT**

- Small pointed jaws fit into small grooves and recesses
- Resolution: 0.01mm/0.0005"
- Buttons: on/off, zero, mm/inch
- Automatic power off, move the digital unit to turn on power
- Battery CR2032
- Data output
- Made of stainless steel
- Optional accessory: data output cable (code **7315-**, **7302-**, **7305-**, for calipers without built-in wireless)

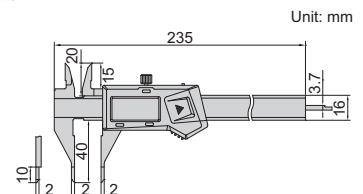
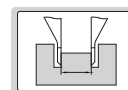
**1169-150**

| Code              | Range        | Accuracy | Wireless          |
|-------------------|--------------|----------|-------------------|
| <b>1169-150</b>   | 0-150mm/0-6" | ±0.03mm  | no                |
| <b>1169-150WL</b> |              |          | built-in wireless |